

Huntington Floor Plan

Master Bath (10' x 5' 6") - Attached to the bedroom provides additional privacy. Stand-up shower with cabinet storage.

Main Bath (13' x 5' 6") - This large bathroom gives you all the storage space you could need w/lower cabinets & a separate linen closet.

Kitchen w/Snack Bar & Dining Room (17' x 13') - The centerpiece of the unit, great for entertaining and cooking.

Pantry - Shelving & hot water heater

Foyer with Stairs - leads to a private entry-way.

Living Room (17' 6" x 15' 6") - with cathedral ceilings is spacious enough to accommodate large furniture & and a full size TV for your entertainment.

Third Bedroom (11' 6" x 10') - Turn this cathedral room into a bedroom or an office to fit your lifestyle. Walk-in-closet available in select units.

Private Balcony - Sliding glass doors welcome your guests to a covered balcony large enough for outdoor dining and your enjoyment.

Second Bedroom (12' x 11') - A spacious room with ample closet space provided (6' x 3').

Master Bedroom (15' 6" x 11') - A large room with plenty of space for all your necessities. This room includes a 7' wide closet.

Laundry - Separate space with privacy doors and a full size washer and dryer.

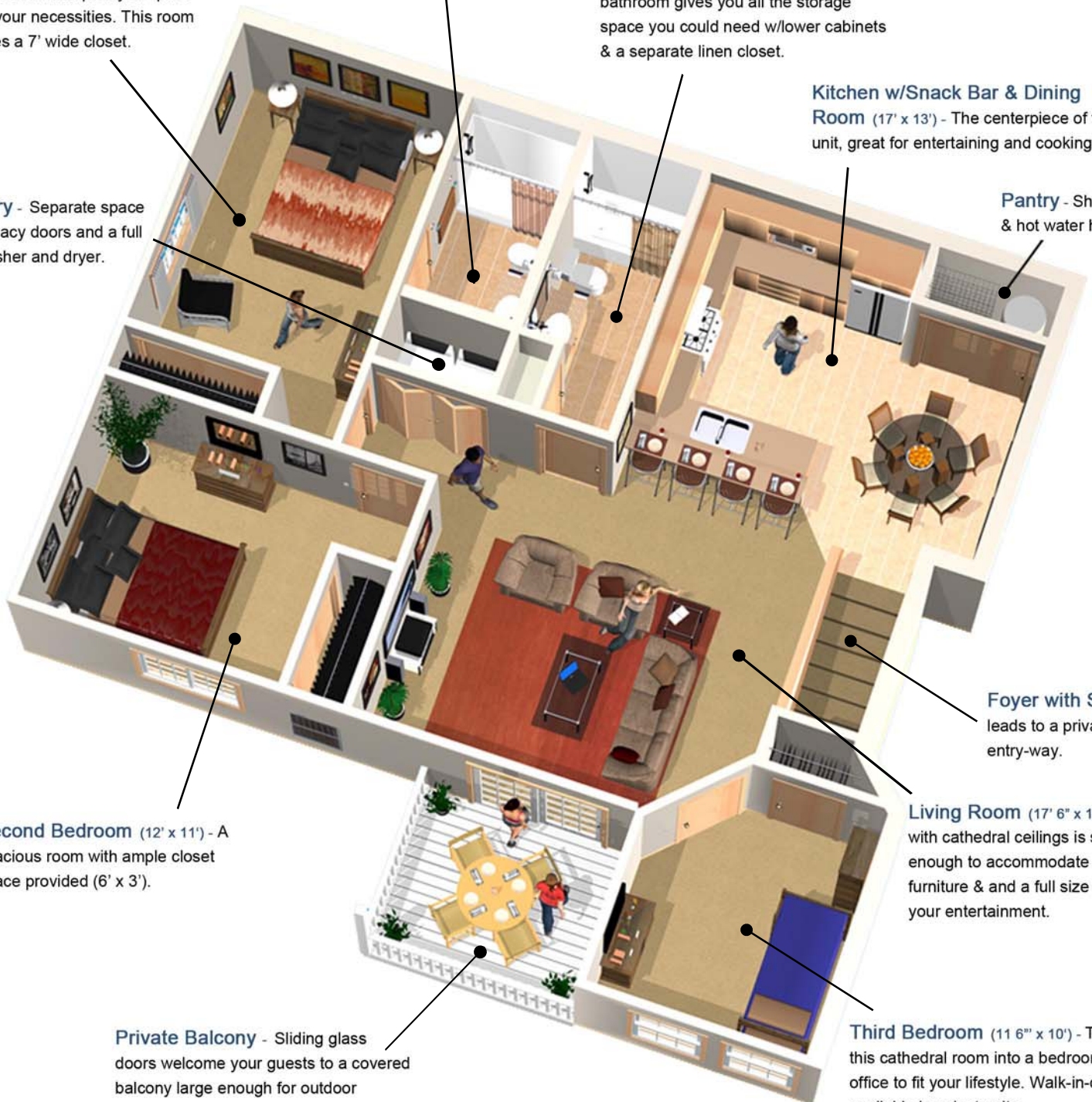

** Not all units are identical. Measurements and modifications are subject to change.